

SCHOOL



The red brick building known as School was built in the late 17th Century. The Masters' 'thrones' and benches for the pupils are still in place at one end. The walls are hung with 15th century Flemish tapestries and with portraits of recent headmasters. This versatile venue can be used for a wide variety of events: a drinks reception, wedding breakfast, celebratory dinner, lecture or music recital, to name just a few.

Capacity

120

Dimensions

21.85m x 10.58m

Lighting

Two 12-candle bulb chandeliers, four 2-candle bulb side lights and recessed lighting in the ceiling all on dimmer control switches.

Sound

Public address system available upon request.

Power

Nine double power points distributed over the walls and floor.

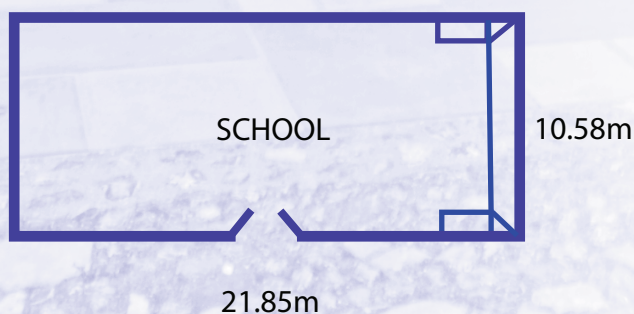

COLLEGE HALL



College Hall is the original dining hall for the Scholars, with panelling dating from the middle of the 16th century. The medieval dining area with its high timber ceiling and wooden benches, is suitable for dinners, banquets, lectures and themed evenings.

The Hall is lined with fixed benches and tables. Seating can also be arranged in the body of the Hall. There is a raised platform at one end (8.5m x 3.5m), on which the 'high table' can seat up to 24.

Capacity

120

Dimensions

17m x 8.5m

Lighting

Side tables lit by halogen spot lights, picture lights and track lighting directly towards top table.

Sound

Public address system available upon request.

Power

Eight double socket outlets.

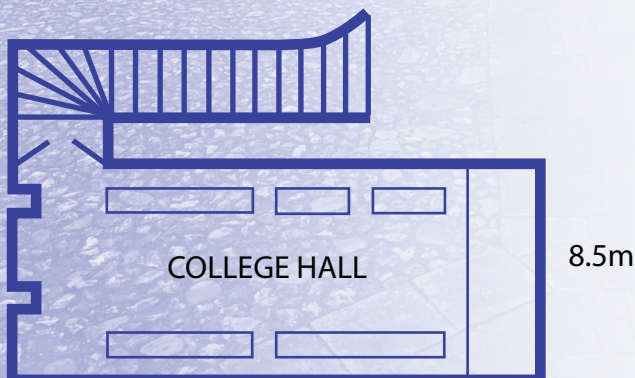

17m

HUNTER TENT



The cricket pavilion was built in the 1930s. The main room leads out onto the ground floor terrace with benches and panoramic views of the cricket grounds. Upstairs there is a balcony overlooking the grounds and the Itchen Valley. Both rooms have access to the kitchen and are suitable for medium sized parties, informal dinners and barbecues. A marquee can be added if required for larger functions.

Capacity

Table and benches downstairs seat 40. Additional seating can be added to accommodate a maximum of 50. Seating capacity upstairs is also 50.

Dimensions

Ground Floor 10.5m x 5m
Top Floor 8.3m x 6.8m

Lighting

Fluorescent strip lighting in both rooms.

Sound

Public address system available upon request.

Power

Two double power points in each room.

GARDENS & MARQUEES



The College has three excellent marquee sites. All are situated alongside buildings, which allows for flexibility and the ability to add variety to your occasion.

Our grounds are also available for team building exercises and corporate fun days.

